



DAVIS JOINT UNIFIED SCHOOL DISTRICT
FACILITIES MASTER PLAN

EDUCATIONAL PROGRAM VISION / SENIOR HIGH **3.5** SECTION



This page has intentionally been left blank.

SECTION 3.5



EDUCATIONAL PROGRAM VISION / SENIOR HIGH



Furniture

- Furniture should accommodate varied seating arrangements and group sizes.
- Built-in seating should be designed to facilitate group discussion.



Finishes

- Durable, weather-proof finishes such as concrete.
- Natural finishes such as treated wood.
- Areas for presentation should include writable surfaces and areas where mobile projectors could be used.
- Finishes should be appropriate to supplement themed activities such as Science, Art, Woodshop, or Robotics projects.



Equipment

- Lighting may be provided as necessary to meet safety concerns or supplement daylighting in deeply shaded areas.
- Integrate technology into these areas, providing presentation abilities, wireless internet, exterior electrical outlets, and outdoor speakers / amplification at large group lecture areas.



Ernest McBride Senior High School

PROGRAM ACTIVITIES

- Instructional lessons, group and individual work with active and passive spaces supporting student's various learning styles.
- Open, multi-purpose outdoor stations for classes to explore independent learning (art, science, ecology, etc.)
- Garden
- Social gathering and small group meeting space



San Marcos High School

DESIGN OBJECTIVES & CHARACTERISTICS

Outdoor spaces adjacent to classrooms and between classroom wings can be utilized as learning spaces. These spaces provide teachers with the opportunity to engage students with lessons and projects in a controlled and safe environment outdoors.

Spaces should accommodate a range of group sizes, from individual study to whole-class discussions, and should allow "messy" multipurpose areas for experimentation.

Landscape should be incorporated into these areas, as appropriate. Plant selection should consider the use of drought resistant species. Trees can be utilized to provide shade.

Outdoor learning spaces should be inviting and engaging. Utilize varied floor materials and vegetation to design the passive and active spaces.

SECTION 3.5



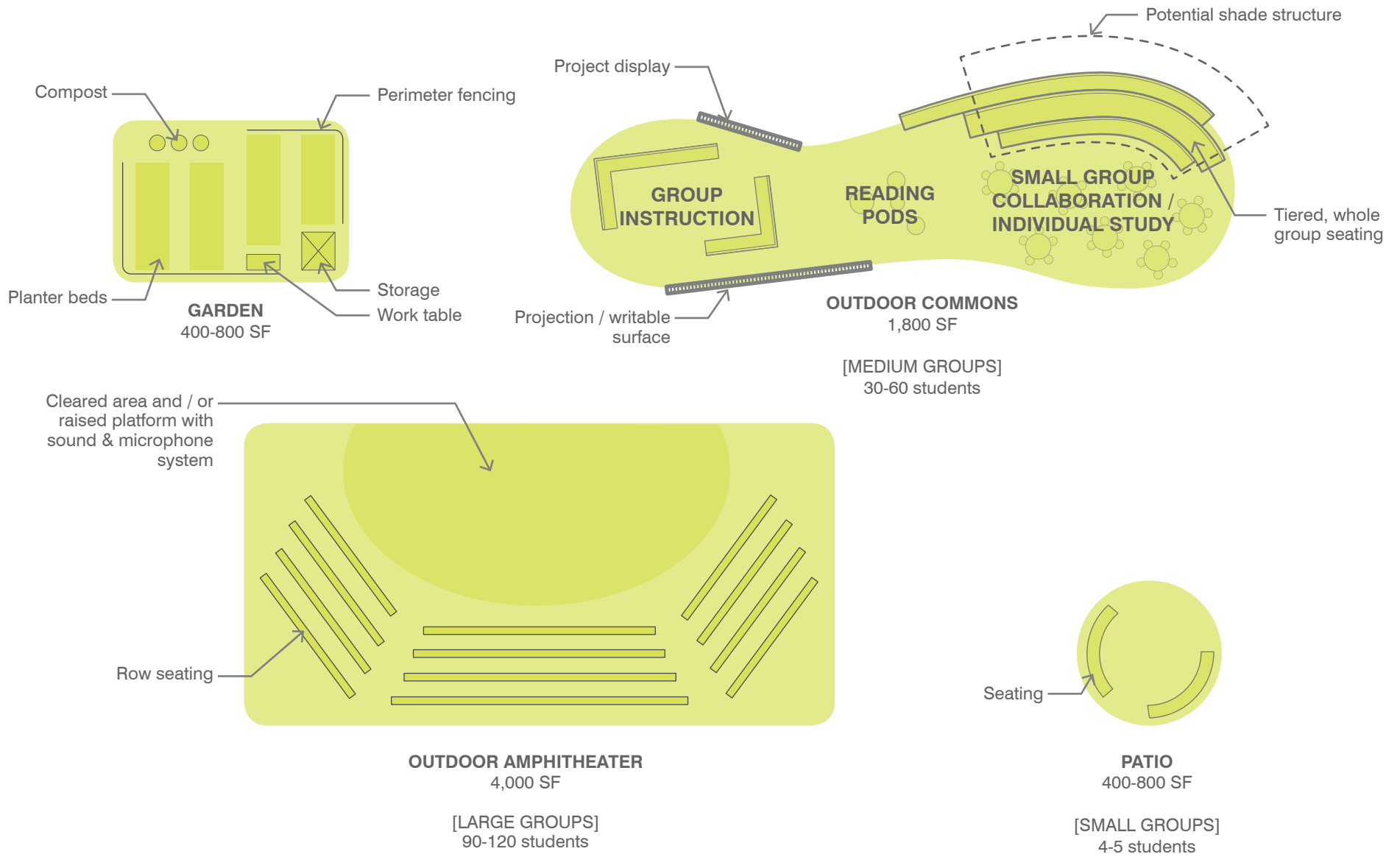

SECTION 3.5





Furniture

- Utilize mobile furniture that can be re-arranged easily and with minimal effort, accommodating individual and group work.
- Include a variety of different / adjustable-height seating options such as soft furnishings and stools.
- Disperse mobile writable surfaces throughout.
- Provide desks to accommodate two to three additional adults (parent volunteers, teachers assistant, etc.).



Finishes

- Flooring should be carpet in whole-group area where students may be seated.
- Flooring should be resilient at the sink area and other areas designated as project area(s).
- Finishes should contribute to the acoustical qualities; include materials that absorb sound within the space.
- Provide writable and tackable wall surfaces.

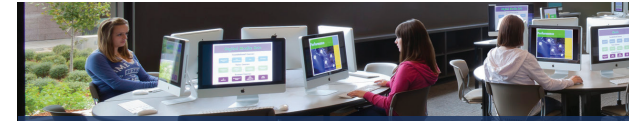

Equipment

- Computer “mini-lab” to include 10 to 12 computer stations.
- Integrated technology that accommodates presentation, documentation, seamless internet access, and student devices should be provided.
- Mobile presentation station
- Sink with bubbler

PROGRAM ACTIVITIES

- Critical foundational skills, strategies, and experiences
- Project-based learning / workshop teaching
- Hands-on / tactile learning
- Collaborative groups / team and independent learning
- Aside conversations between teacher and student(s)
- Art, science or music labs
- Interdisciplinary, learner-centered instruction with full integration of technology.
- Active and passive learning activities.
- Large lecture, small group, and individual work.
- Core subject instruction: Language Arts, Social Studies, Mathematics, etc.
- Material and project storage
- Material preparation

classroom configuration possibilities using the same furniture kit:

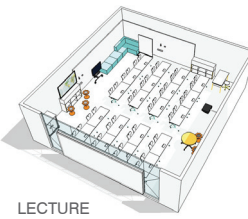

LECTURE

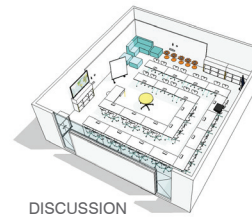

DISCUSSION



ZONED

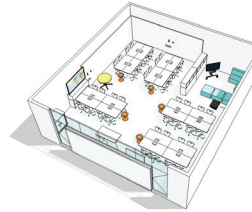

SMALL GROUP

Flexible Furniture

DESIGN OBJECTIVES & CHARACTERISTICS

Promote 21st Century learning skills, collaboration, communication, critical thinking, and problem solving.

Spaces should be open, inviting, and engaging. Color and lighting strategies should be used appropriately, with technology in mind.

Consider lower ceilings that provide a sense of scale in areas that are dedicated to small groups or have an individual focus.

Utilize every space as a learning space through the use of flexible furniture and writable surfaces that are dispersed throughout and easily accessible by all users.

Emphasize the connection to the outdoors through window systems and/or doors / operable storefront systems.

SECTION 3.5



EDUCATIONAL PROGRAM VISION / SENIOR HIGH STANDARD CLASSROOM

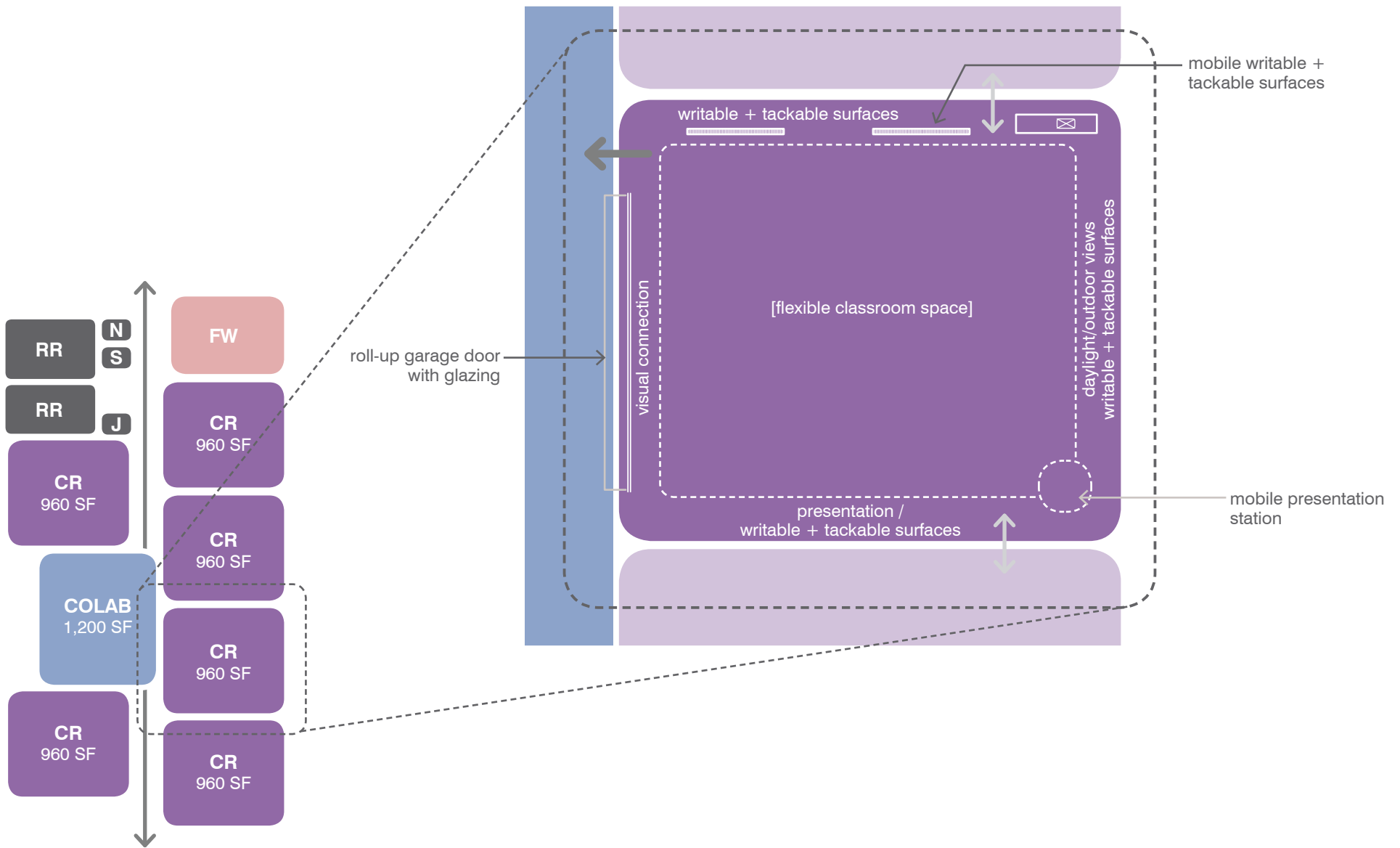

SECTION 3.5



Furniture

- Utilize mobile furniture that can be re-arranged easily and with minimal effort.
- Provide a variety of seating types and heights.
- Utilize bench seating along or built into the wall.



Finishes

- Flooring should be durable and easy to clean.
- Finishes should contribute to the acoustical qualities; include materials that absorb sound within the space.
- Provide writable and tackable wall surfaces.



Equipment

- Provide seamless internet access and charging stations for student devices.



San Marcos High School

PROGRAM ACTIVITIES

- Exploratory learning in groups or individually
- Peer collaboration
- Creativity and innovation



Ernest McBride Senior High School

DESIGN OBJECTIVES & CHARACTERISTICS

Collaboration areas are fully-flexible spaces that allow students to gather for discussion and problem-solving in any variety of configurations.

Treat Colabs as continuous spaces, rather than a destination if possible, so that classrooms can easily open and close to it with team rooms sprinkled throughout.

Allow students to leave artifacts of learning; students should have the ability to “make their mark.”

Teachers should be able to maintain visibility into and out of this space, to ensure full-class supervision.

Provide “excessive” writable surfaces.

SECTION 3.5



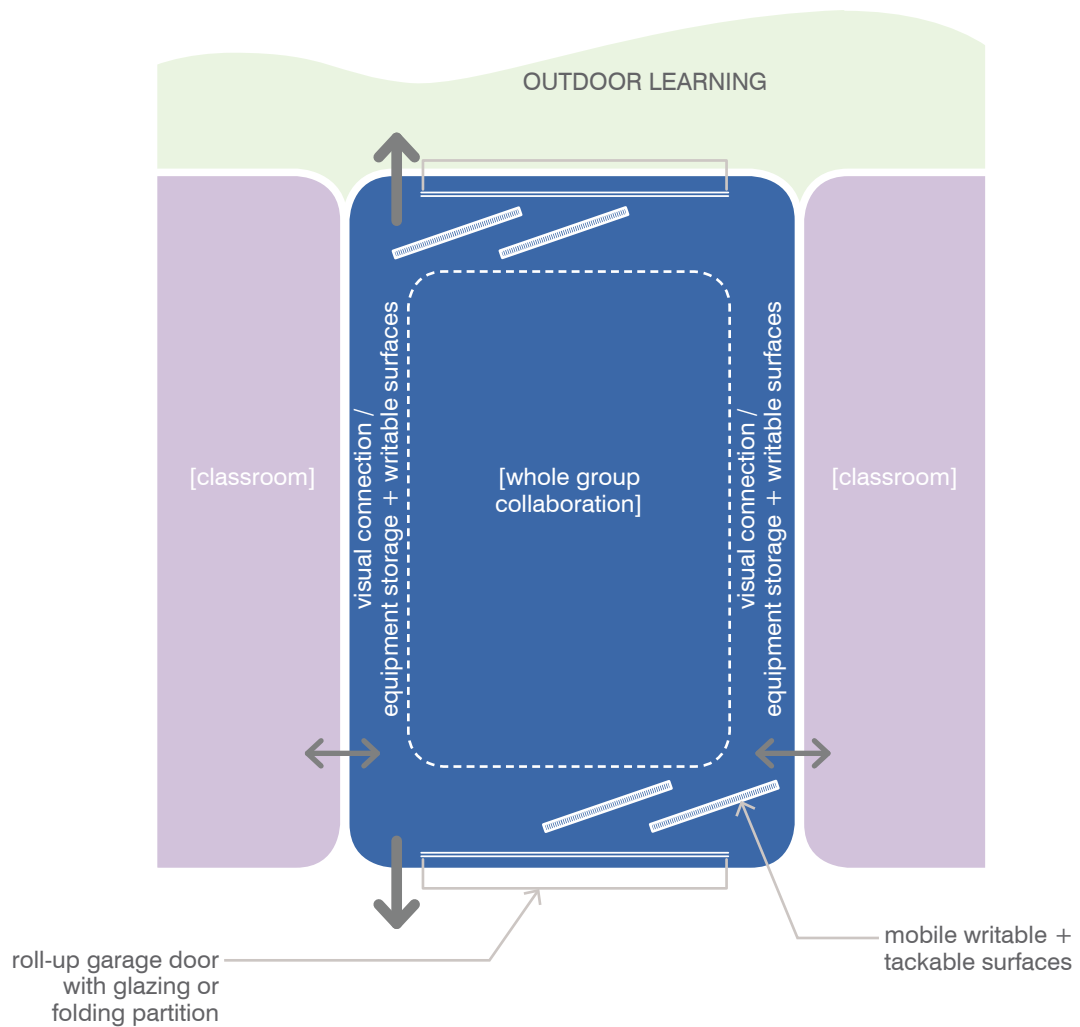

SECTION 3.5





Furniture

- Provide furniture that accommodates whole group lecture, small group work, and individual work.
- Consider furniture on casters. Include mobile storage and keep built-in casework to a minimum.
- Student tables and chairs should have the ability to adjust height.
- Provide a mobile teacher demonstration table.



Finishes

- All work surfaces should be chemical resistant and science grade.
- Flooring should be resilient, durable, and easy to clean.
- Consider furniture on casters with the ability to adjust height.
- Provide writable surfaces at presentation area.



Equipment

- Provide outlets at each built-in table that are protected from spills and other debris.
- Provide integrated video camera to magnify teacher instruction of hands-on techniques.
- Provide data/power/gas as required. Consider ceiling-mounted retractable system to maximize flexibility.
- Incorporate interior and exterior sinks for easy clean-up.



South Tahoe High School

PROGRAM ACTIVITIES

- Large group instruction and demonstration
- Individual project-based learning and investigation
- Science lab experimentation and creative exploration
- Cross-collaboration with other fields of study
- Showcase and presentation of student work



Ernest McBride Senior High School

DESIGN OBJECTIVES & CHARACTERISTICS

Accommodate Next Generation Science Standards while providing space for students to move and explore.

“Future-proof” the space; provide full flexibility and adaptability.

Create easy access to exterior learning courts.

Science Rooms should be accompanied by a Faculty Work room for materials preparation.

Co-locate with Technology, Engineering, Arts, and Math for STEM/STEAM curriculum integration.

SECTION 3.5

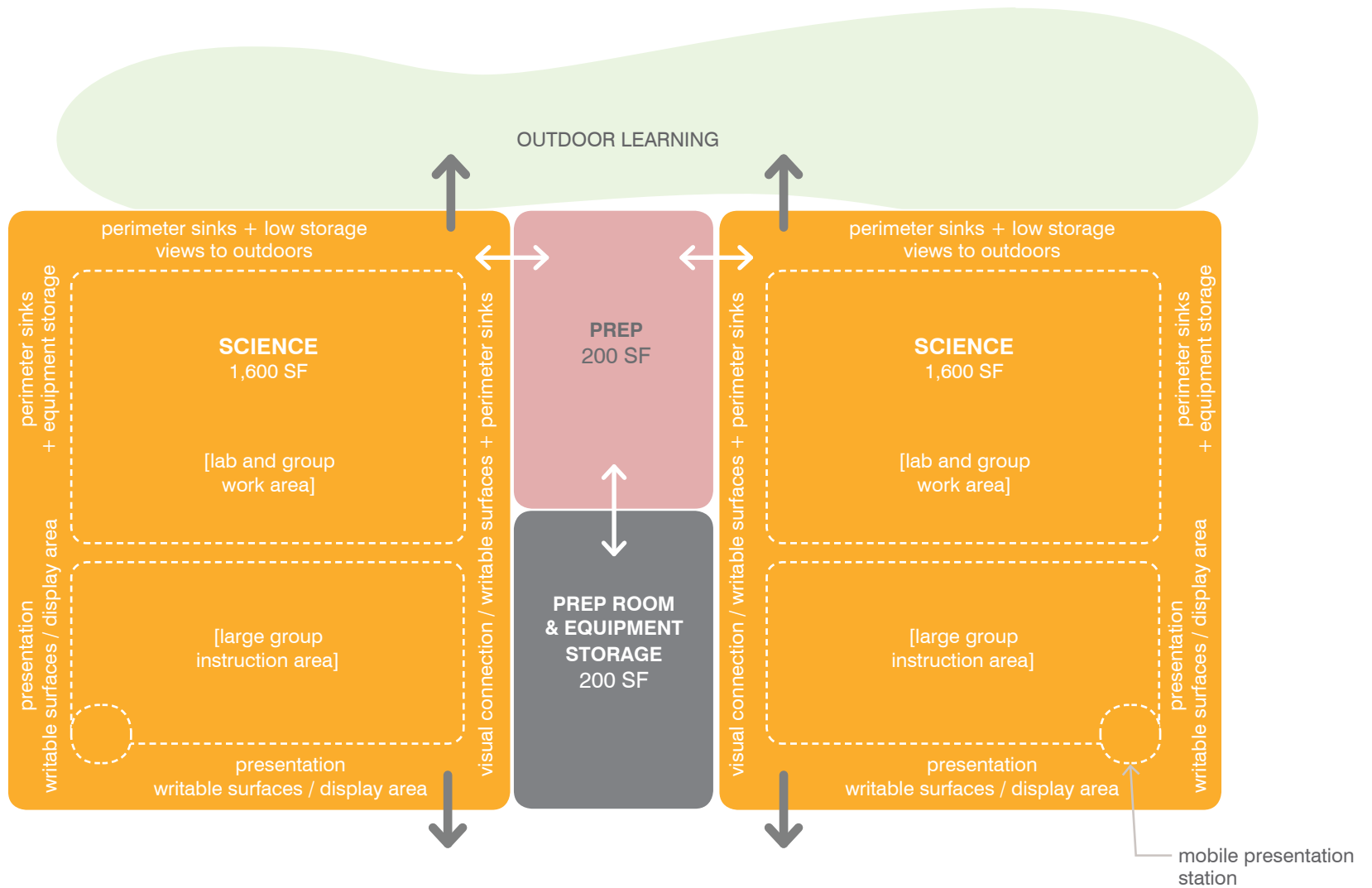

SECTION 3.5





Furniture

- Provide ergonomic workstations. Consider workstations that can adjust to sitting and standing heights.



Finishes

- Flooring should be durable and easy to clean.
- Provide writable and tackable surfaces throughout the space as wall finishes and as mobile boards.



Equipment

- Include presentation equipment with mobile presentation station.
- Computer station for every student with industry-standard drafting / coding programs.
- Consider a large-format plotter.



South Tahoe High School

PROGRAM ACTIVITIES

- Large group instruction and demonstration
- Group and individual project-based learning
- Computer-based projects
- Digital drafting
- Computer coding



South Tahoe High School

DESIGN OBJECTIVES & CHARACTERISTICS

Design open, flexible classrooms with space and infrastructure that will respond to changing technology and program needs.

Provide ample opportunity to showcase student work.

Provide hands-on, “real world” scenario for students to experience possible career applications.

Co-locate with Science, Arts, and Math for STEM/STEAM curriculum integration.

SECTION 3.5



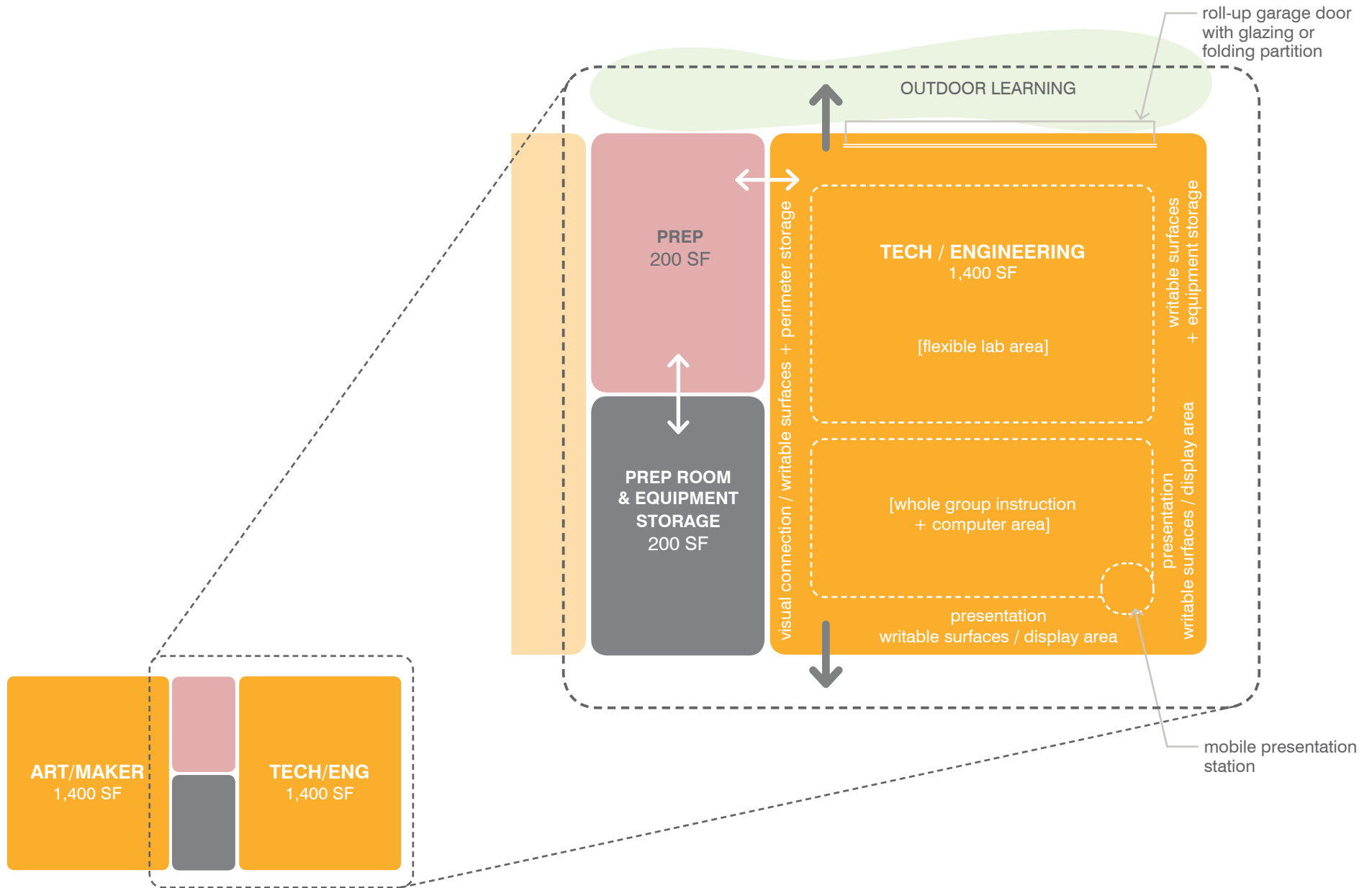

SECTION 3.5





Furniture

- Provide furniture that accommodates full flexibility to open floor space wherever needed.
- Include storage (mobile where possible) for materials and in-progress projects.
- Student tables and chairs should have the ability to adjust height.
- Deep counter areas for large paper storage, paper cutters, light tables, and other equipment.



Finishes

- Flooring should be resilient, durable, and easy to clean.
- Provide writable and tackable surfaces throughout the space as wall finishes and as mobile boards.



Equipment

- Include presentation equipment with mobile presentation station.
- For 2D art, provide paper cutter, light table, and other relevant equipment.
- Include computer stations away from “messy” art space for digital illustration and photography.
- For 3D / Maker spaces, consider industry-standard equipment such as a 3D printer or laser cutter.



San Marcos High School

PROGRAM ACTIVITIES

- Large group instruction and demonstration
- Group and individual project-based learning
- Creation and presentation of art exhibits
- 2D drawing, sketching, painting, mixed media
- 3D art sculpting, building
- Digital illustration and photography
- Exploration through art and construction



Ernest McBride Senior High School

DESIGN OBJECTIVES & CHARACTERISTICS

Design open, flexible classrooms with space and infrastructure that will respond to changing technology and program needs.

Provide ample opportunity to showcase student work.

Provide hands-on, “real world” scenario for students to experience possible career applications.

Increase ventilation rates for paint use and operable windows for improved occupant comfort.

Co-locate with Science, Technology, and Math for STEM/STEAM curriculum integration.

SECTION 3.5

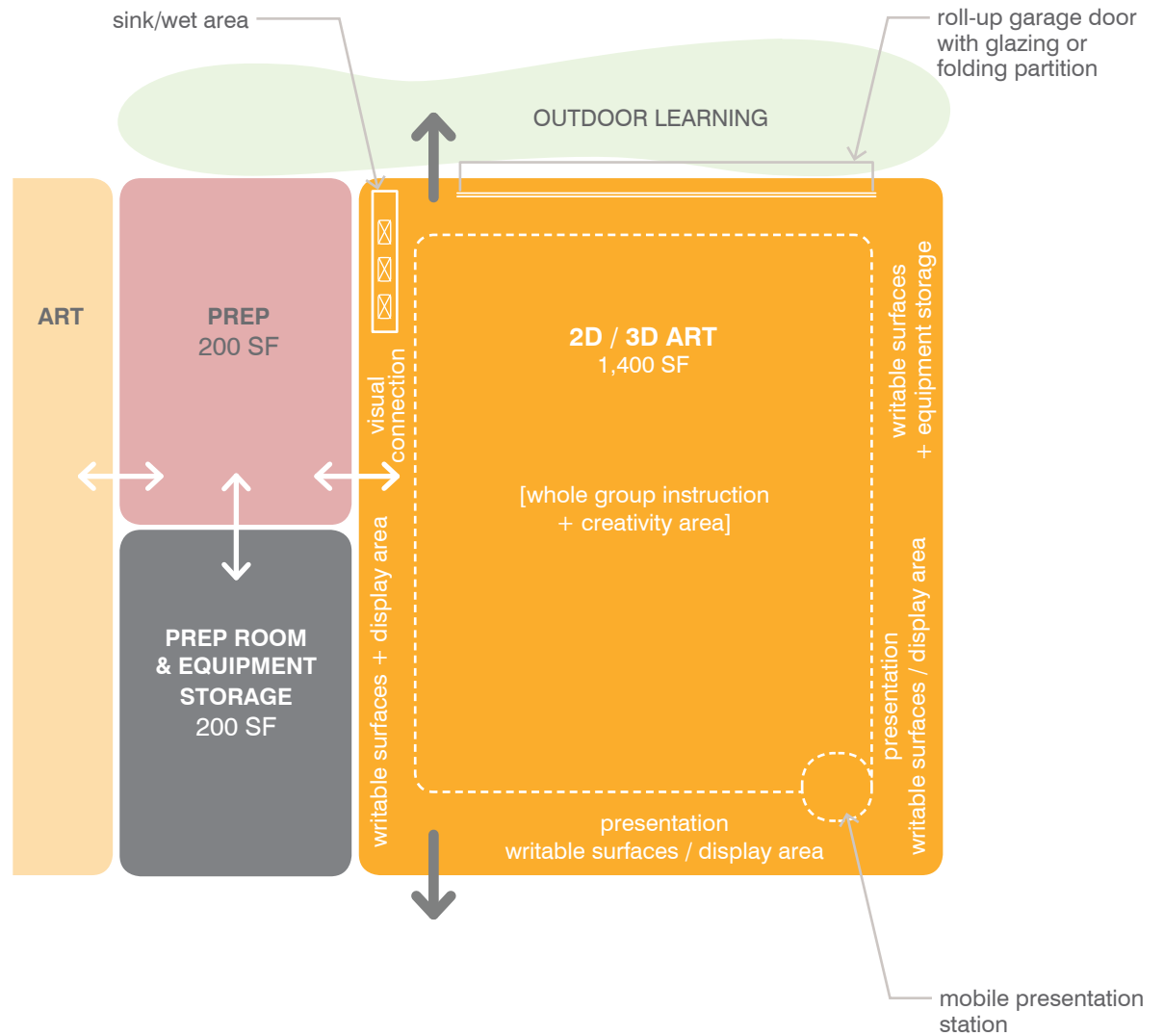

SECTION 3.5





Furniture

- Health office should include casework with work area and lockable storage cabinets, including refrigerated storage.
- Casework at standing and seated working heights for reception and offices.

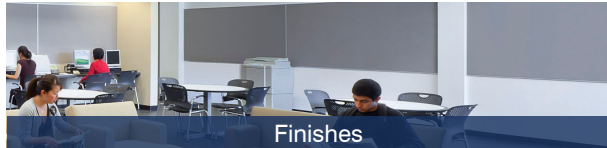

Finishes

- Flooring should be carpet in offices and conference rooms with resilient flooring in work rooms and Health office.
- Walls should be a mix of writable and tackable surfaces.
- Encourage school pride via the use of school colors within the paint palette and display of school branding.



Equipment

- Provide an energy-efficient mix of indirect/direct lighting, with natural daylight and shading devices for personal control.
- Provide digital display(s) for announcements, student work, etc.
- Provide a computer work station to accompany printing/copy machine in Admin and main work rooms.



Private Office

PROGRAM ACTIVITIES

- Welcome center, check-in, front entry
- Administrative duties, attendance, enrollment, supply/record storage
- Conference
- Discipline meetings
- Health support
- Faculty collaboration
- Professional development
- Parent/volunteer resource room



Arcadia High School

DESIGN OBJECTIVES & CHARACTERISTICS

Identify the campus “front door” with clear wayfinding to and through the Administrative offices.

Create a secured entry point onto campus.

Promote collaboration and unity through shared resources, while balancing privacy and confidentiality within private offices and conference rooms.

SECTION 3.5



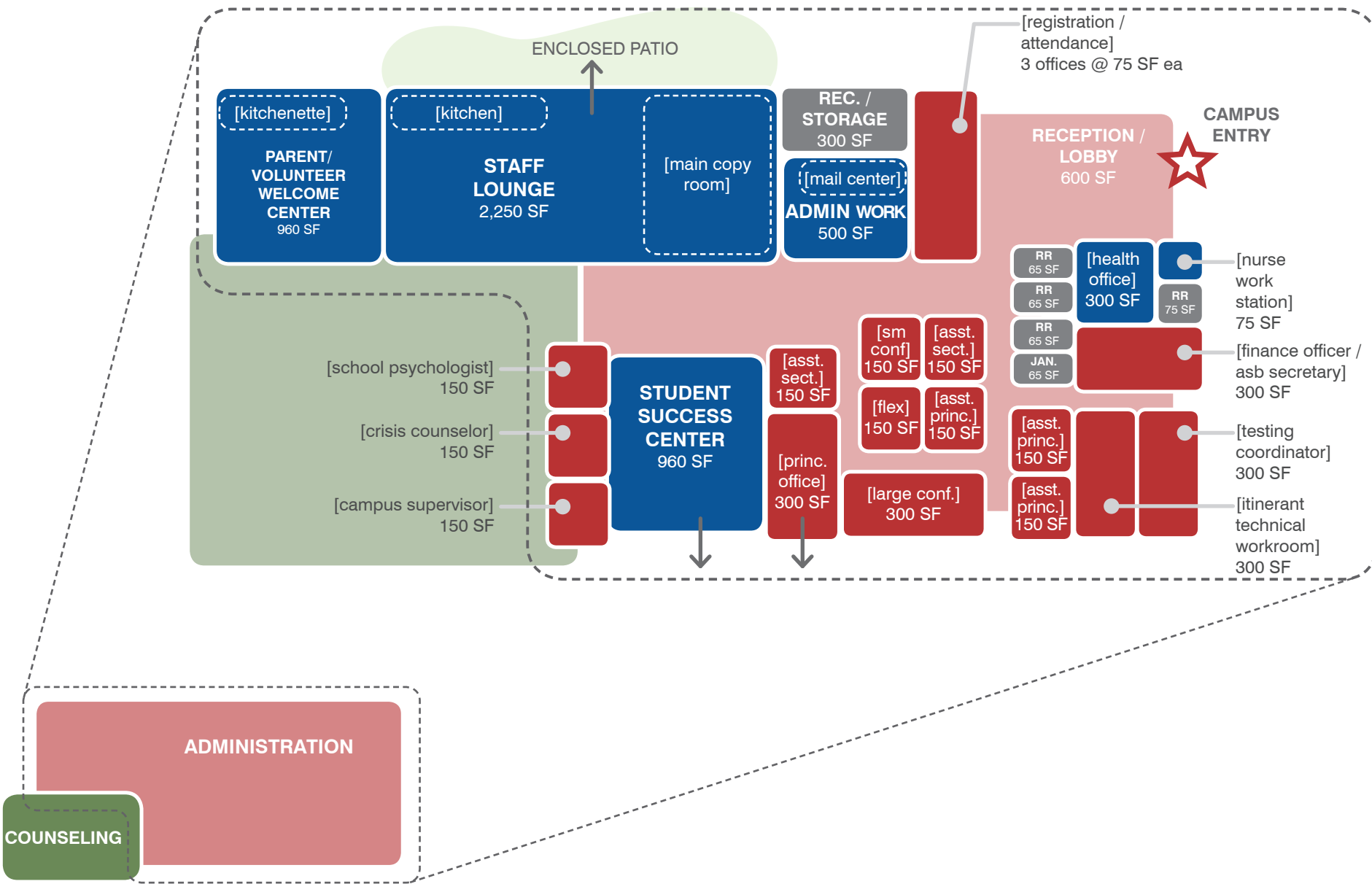

SECTION 3.5



EDUCATIONAL PROGRAM VISION / SENIOR HIGH ADMINISTRATION





Furniture

- Casework at standing and seated working heights for reception area and offices.
- Ergonomic work stations at reception and offices.
- Provide a variety of seating/study options in central area, including soft seating.

Finishes

- Provide a mix of tackable and writable wall surfaces.
- Select acoustically absorptive material and add operable blinds to private offices and conference rooms, for confidentiality.

Equipment

- Provide computer work stations in each office and at reception desk.
- Consider computer work stations within the central area for student use.
- Provide outlets for students to plug-in their devices.
- Include a digital display for announcements, student achievements, etc.



Private Office

PROGRAM ACTIVITIES

- Check-in, reception
- Conference / meetings
- IEP meetings
- Counseling
- One-on-one instruction
- Small group instruction
- Confidential offices



Ernest McBride Senior High School

DESIGN OBJECTIVES & CHARACTERISTICS

Support students by providing an environment where they can engage openly or privately with counselors.

Access study and resource materials for college preparation.

Create and open, inviting atmosphere with ample visibility within and throughout the counseling suite.

SECTION 3.5



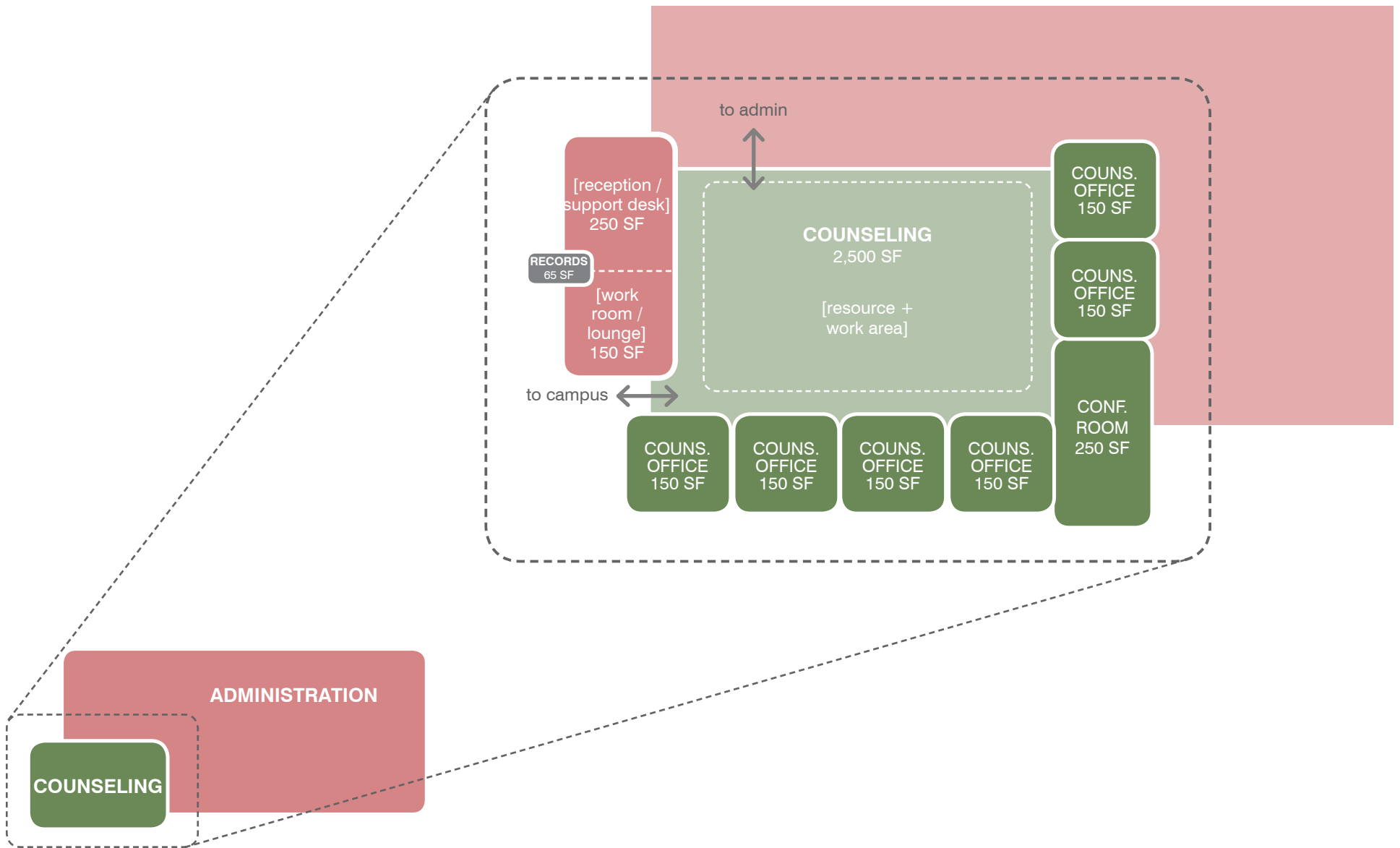

SECTION 3.5





Furniture

- Casework at standing and seated working heights for reception area and offices.
- Ergonomic work stations at reception and offices.
- Utilize mobile furniture that can be re-arranged easily and with minimal effort, accommodating individual and group work. Include soft seating.



Finishes

- Provide a mix of tackable and writable wall surfaces.
- Select acoustically absorptive material and add operable blinds to private offices and conference rooms, for confidentiality.



Equipment

- Provide computer work stations in each office.
- Provide outlets for students to plug-in their devices.
- Include a display area for announcements, student achievements, etc.
- Presentation technology within each Reading and Inclusion space.



Hawthorne Elementary School

PROGRAM ACTIVITIES

- Check-in, reception
- Conference / meetings
- IEP meetings
- Counseling
- One-on-one instruction
- Small group instruction
- Confidential offices



Samueli Academy

DESIGN OBJECTIVES & CHARACTERISTICS

Provide a welcoming and supportive environment where students can engage with counselors, therapists, and learning resources.

Provide a balance between visual connectivity and acoustic privacy. Include operable blinds at office and conference windows.

Create an open, inviting atmosphere with ample visibility within and throughout the counseling suite.

Treat the Reading and Inclusion rooms similar to standard classrooms, but with lower student loading.

SECTION 3.5



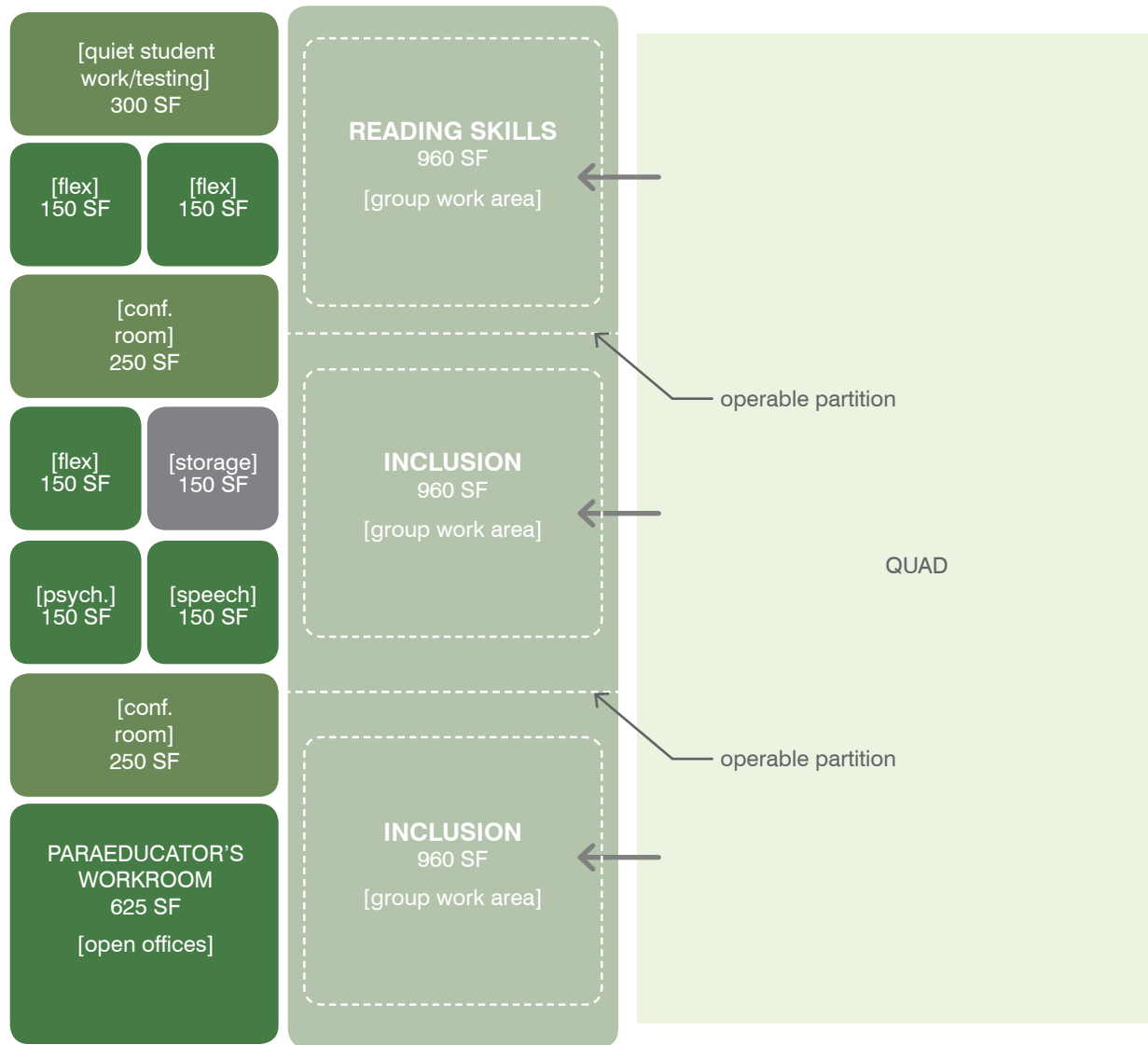

SECTION 3.5





Furniture

- Locker room should have bench seating and personal storage lockers.
- Diving blocks and flag rows for competition swimming.
- Swimming lane lines.



Finishes

- Ensure a slip-resistant pool deck.
- Locker rooms should have slip-resistant epoxy flooring.



Equipment

- Swimming pool pace clock attached to building, and an additional portable clock.
- Digital scoreboard mounted to building.
- Pool utility building contains heater, pump, chemical storage and other equipment that accompanies swimming facilities.



Albany High School

PROGRAM ACTIVITIES

- Large group instruction and demonstration
- Individual project-based learning and investigation
- Science lab experimentation and creative exploration
- Showcase and presentation of student work



Albany High School

DESIGN OBJECTIVES & CHARACTERISTICS

The Aquatics Center is a facility that celebrates the athletics program and students of Davis Senior High School and builds school pride.

Students are able to practice, train, and hone their aquatics skills in a safe and supportive environment. This facility also provides Davis Senior HS the ability to host swim meets and other competitions.

SECTION 3.5



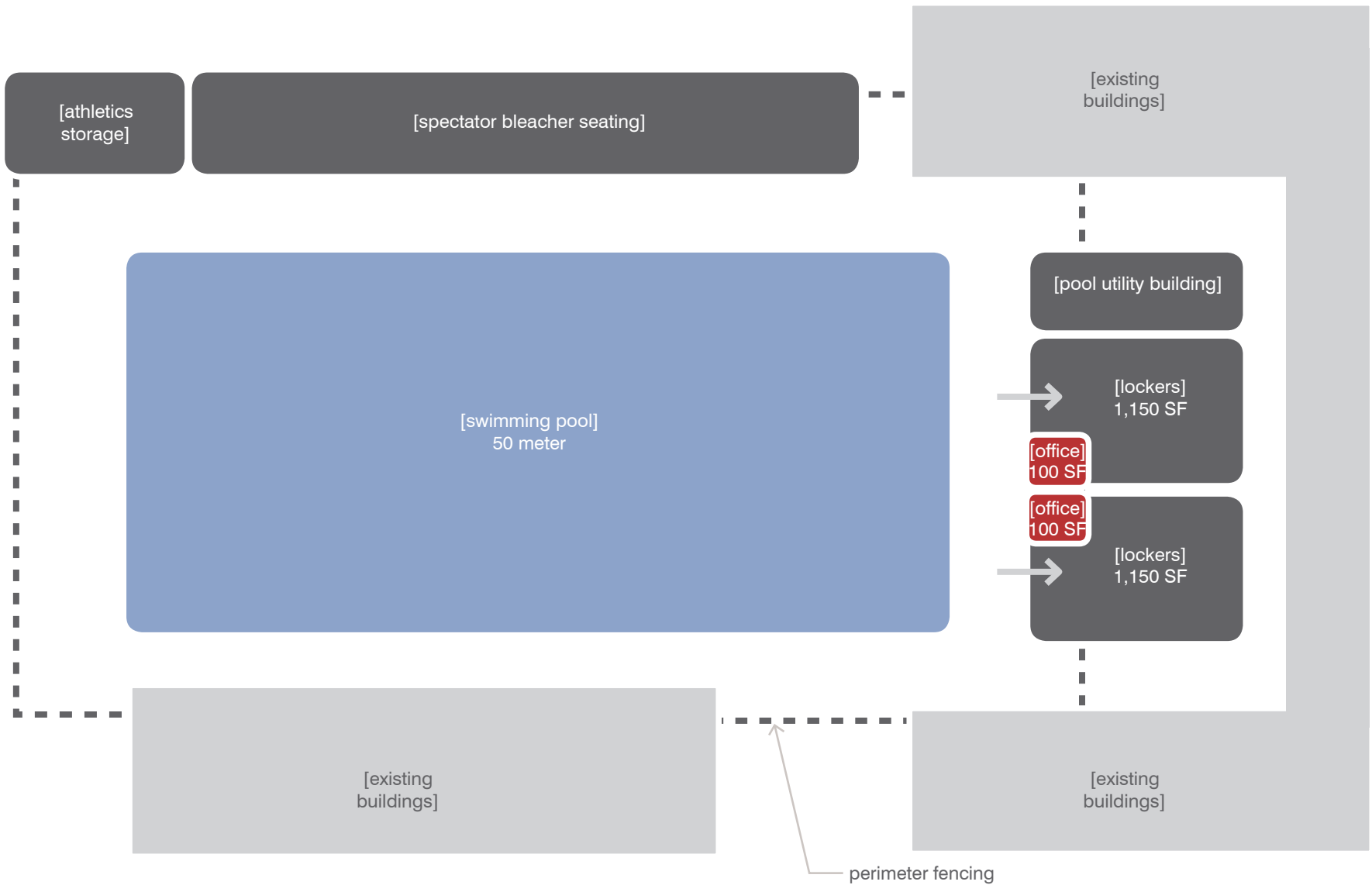

SECTION 3.5





Furniture

- Bench seating in the Team Rooms.
- Padded tables/benches in the Training Room with storage cabinets.
- Flexible classroom furniture within the Shared/County Room.



Finishes

- Provide ample writable wall surfaces within the Team Rooms.
- The Training Room should also have writable wall surfaces, though does not need to be as extensive as in the Team Rooms.



Equipment

- The Training Room should have an ice machine, sink, therapy tub, and computer work station.
- Within the Team Rooms, consider including a monitor with playback capabilities for game film review.
- The Shared/County Room should have presentation/projection equipment.



Westminster High School

PROGRAM ACTIVITIES

- Changing room and personal storage
- Shower and restroom
- Sports therapy
- Group discussion and lecture



San Marcos High School

DESIGN OBJECTIVES & CHARACTERISTICS

This building supports athletics and should be located within close proximity to the football stadium and baseball diamond.

Team rooms provide a space for the visiting team to meet, change, and discuss game-play.

The Training Room serves as a sports therapy space and could include padded tables/benches, a cold tub, an ice machine, medical supply storage, and a space/room for a desk with computer station.

The Team and Training Rooms should have minimal windows and be well ventilated.

This building include a separate room, similar to a standard classroom, that is intended for shared use with the County.

SECTION 3.5



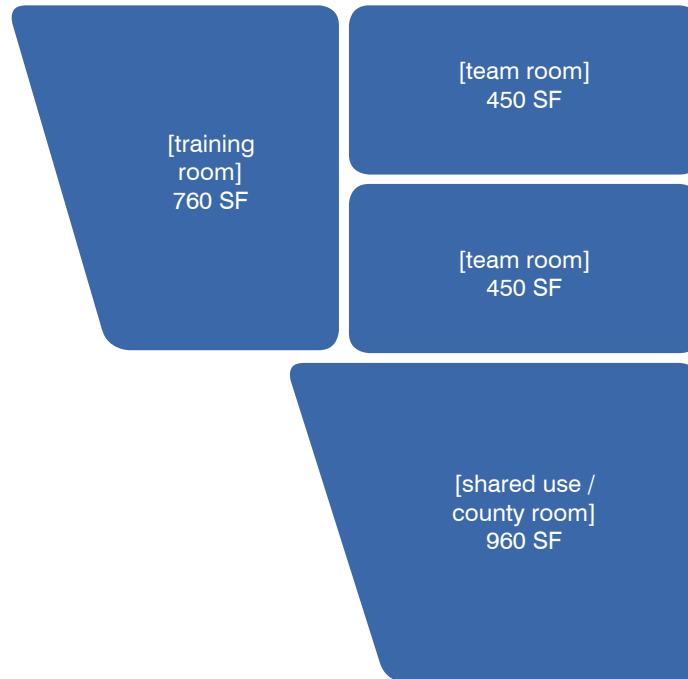

SECTION 3.5





Furniture

- Administration office should include casework at standing and seated working heights for reception and offices.
- MPR should contain tables and chairs or bench seating that can be stored easily for a clear floor.

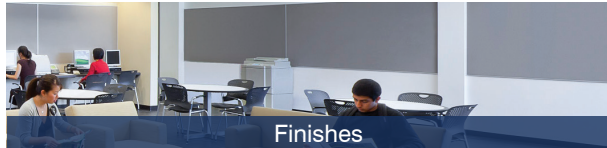

Finishes

- Flooring should be carpet in offices and conference rooms with resilient flooring in work room.
- Walls should be a mix of writable and tackable surfaces.
- Use resilient flooring in the MPR.



Equipment

- Provide an energy-efficient mix of indirect/direct lighting, with natural daylight and shading devices for personal control.
- Provide casework or digital display(s) for announcements.



Arcadia High School

PROGRAM ACTIVITIES

- Welcome center, check-in, front entry
- Administrative duties, attendance, enrollment, supply/record storage
- Conference
- Faculty collaboration
- Professional development



Hector Godinez High School

DESIGN OBJECTIVES & CHARACTERISTICS

This building serves as a “home base” for the Adult and Community Education program who shares classroom space with Davis Senior High School.

Utilize signage that clearly identifies this building as a separate facility from Davis Senior HS, giving it its own identity and presence.

Provide a welcoming environment that feels supportive for faculty and students alike.

SECTION 3.5



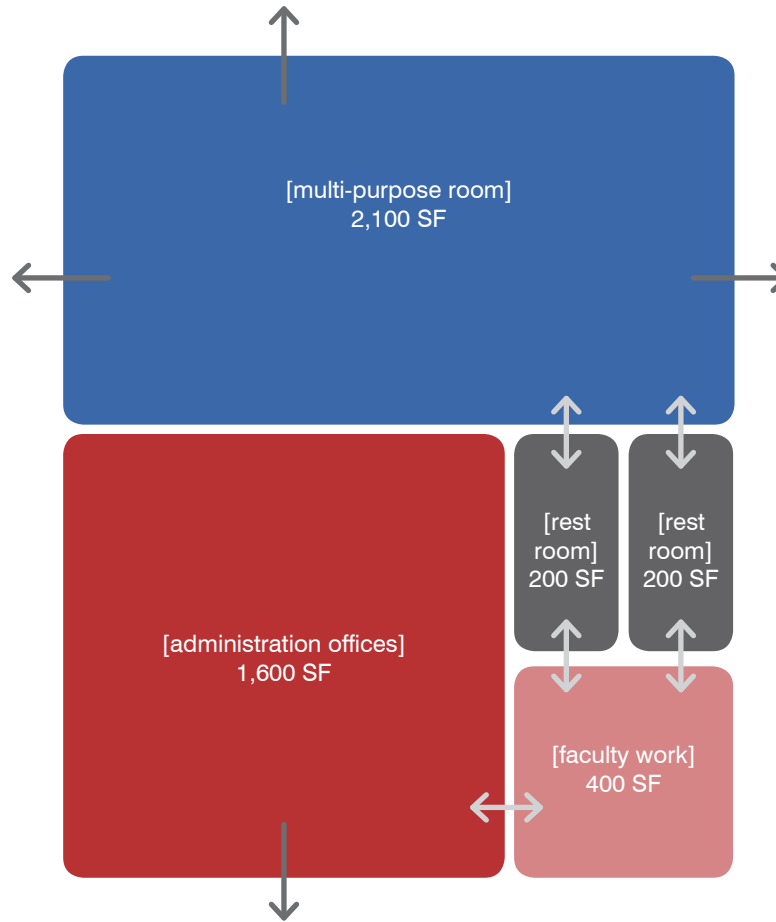

SECTION 3.5

